



## STEVE CLARK YMCA AND STUDENT WELLNESS CENTER ON THE CAMPUS OF WICHITA STATE UNIVERSITY

The Greater Wichita YMCA's tenth branch location, the Steve Clark YMCA, is located on the WSU Innovation Campus. The facility will serve Wichita State students, faculty, and staff, all Y members, and the entire community.

### FACILITY INFORMATION

This 77,000 sq. ft. building houses three organizations and offers:

- Access from 21st Street, connecting WSU's main and Innovation campuses
- Health services to students through the **WSU Student Wellness Center**
- Medical services for the community through **Wesley Healthcare Urgent Care**
- 160 parking spots - designated for those using the facility
- Large, open spaces for studying, social time, relaxing, and community building
- Rooms for organizations to collaborate and hold meetings and small events

The **55,000 sq. ft. YMCA** facility will offer:

- Cushioned track (7 laps/mile) around the courts, fitness floor, and lobby
- 3 studios for group exercise, programs, meetings, and activities
- 3 locker rooms with family changing rooms
- 2 hardwood courts for pick-up basketball, pickleball, and other activities
- Kid Zone Drop-In Nursery with Kid Zone PLUS for student use
- Group exercise classes, personal training, nutrition coaching, and more
- Indoor/outdoor hybrid spaces with turf areas for more and larger classes
- State-of-the-art cardio and strength equipment and free weights
- Tech-enhanced fitness areas including boxing and virtual reality stations
- Guest passes are available for community participants and visitors
- YMCA members can use the aquatics center inside WSU's Heskett Center

### LOCATION HOURS

- Monday-Thursday 5:30AM-11PM
- Friday 5:30AM-9PM
- Saturday 8AM-8PM
- Sunday 8AM-10PM

### CONTACT INFORMATION

**STEVE CLARK YMCA**, 2060 N. Mid-Campus Drive, Wichita, KS 67208  
O 316.776.8370 E [steveclarky@ymcawichita.org](mailto:steveclarky@ymcawichita.org)

**GEORGE SORENSEN**, Branch Director, Steve Clark YMCA  
O 316.776.8371 E [george.sorensen@ymcawichita.org](mailto:george.sorensen@ymcawichita.org)

Find schedules and more information in the Greater Wichita YMCA app or by visiting [YMCAWichita.org/SteveClarkYMCA](http://YMCAWichita.org/SteveClarkYMCA).



**FOR YOUTH DEVELOPMENT®  
FOR HEALTHY LIVING  
FOR SOCIAL RESPONSIBILITY**

### ABOUT THE GREATER WICHITA YMCA

Founded in 1885, we remain a volunteer-lead, mission-driven, 501(c)(3) non-profit organization. Today we employ 1,400+ and serve 185,000+ members. The region's largest provider of licensed child care, before and after school programs, summer camp, youth sports, group exercise classes, and health and wellness programs - we serve 300,000+ neighbors annually regardless of their ability to pay through 100+ service sites, partnerships, and outreach efforts, ten branches in Andover, El Dorado, Newton, and Wichita, four Outdoor Water Parks, three YMCA Farha Sports Centers, and Camp Hyde.



# STEVE CLARK YMCA AND STUDENT WELLNESS CENTER ON THE CAMPUS OF WICHITA STATE UNIVERSITY

## FIRST FLOOR LAYOUT

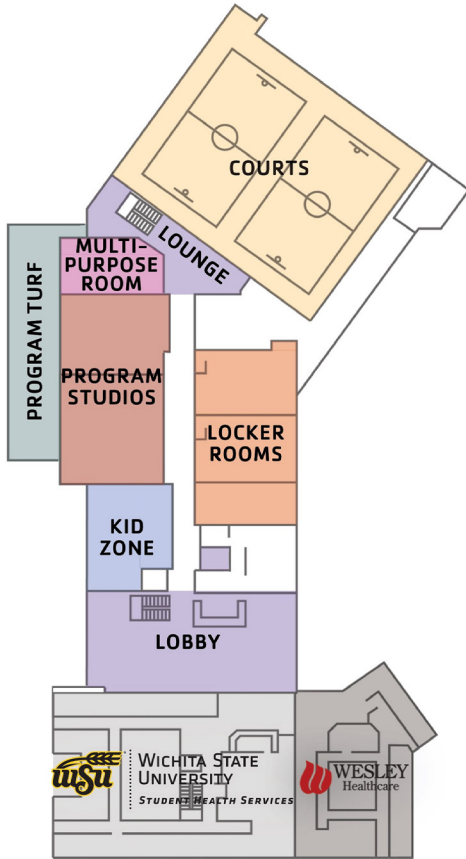

## SECOND FLOOR LAYOUT

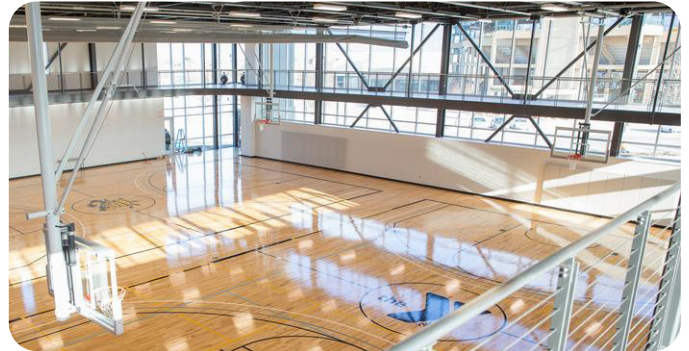

Find hours, schedules, information, photos, and more online at [YMCAWichita.org/SteveClarkYMCA](https://YMCAWichita.org/SteveClarkYMCA)